

GREENLAND
SENDANG
RESIDENCE



CLUSTER
Riviera



green living for modern family

A luxury residence with green and modern atmosphere in Cirebon City
Where the comfortable and green environment meet in harmony



ADELIA



Adelia

Bangunan :
48 m²

Muka :
6 m

- 2
- 1
- 1
- 1
- 1



BRITNEY



ORCHID

Bangunan :
68 m²

Muka :
6 m

- 3
- 2
- 1
- 1
- 1



ORCHID



ALENA



Alena

Bangunan :
80 m²

Muka :
6 m

- 3
- 2
- 1
- 1
- 1

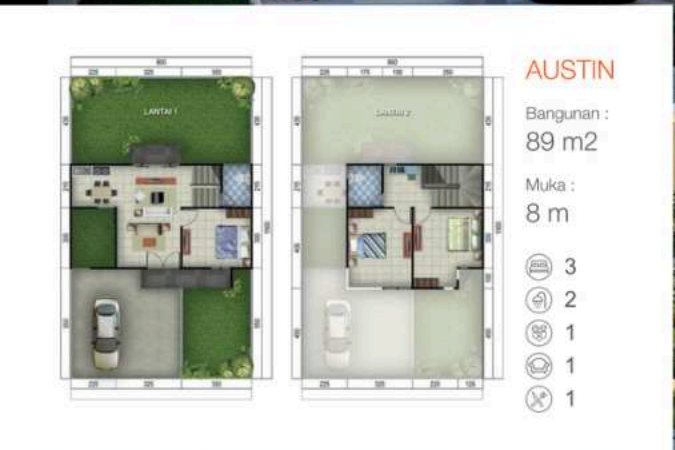

AUSTIN

Bangunan :
89 m²

Muka :
8 m

- 3
- 2
- 1
- 1
- 1



AUSTIN



HELICONIA



Heliconia

Bangunan :
89 m²

Muka :
8 m

- 3
- 2
- 1
- 1
- 1



Britney

Bangunan :
48 m²

Muka :
6 m

- 2
- 1
- 1
- 1
- 1

ALLURA



Allura

Bangunan :
60 m²

Muka :
8 m

- 2
- 1
- 1
- 1
- 1



CHESTER



Chester

Bangunan :
65 m²

Muka :
9 m

- 3
- 1
- 1
- 1
- 1



Chester DELUXE

Bangunan :
75 m²

Muka :
9 m

- 3
- 2
- 1
- 1
- 1



PLATO



Plato

Bangunan :
82 m²

Muka :
8 m

- 3
- 2
- 1
- 1
- 1



Oliver

Bangunan :
78 m²

Muka :
6 m

- 3
- 2
- 1
- 1
- 1



OLIVER



VALENCIA



Valencia

Bangunan :
82 m²

Muka :
8 m

- 3
- 2
- 1
- 1
- 1



Spesifikasi Lingkungan

Rumah Tanpa Pagar | Saluran Drainase Tertutup | Paving Block SNI
 225 - 300K | Pondasi Jalan batu kali | Barrier Gate Auto | CCTV |
 Mushola | Swimming Pool | Jaringan Cable TV, Internet Multimedia |
 Pengembangan Kawasan

Spesifikasi Bangunan

Pondasi	: Batu Kali
Struktur	: Beton bertulang
Dinding	: Bata dipleseter acian dan dicat
Cat	: Weathershield Premium
Lantai	: Granit Tila 60x 60
Atap	: Rangka Baja ringan
Genteng	: Arcor Flate
Kusen	: Kayu Jati/Nyatoh, Powder Coated
Pintu Utama	: Kayu Jati/Nyatoh, Finishing Melamin
Jendela	: Powder Coated + kaca
Piafon	: GypsumBoard
Sanitar	: Closed duduk, shower kran, TOTO/wetara
Carport	: Tergambar batu koral sikat
Listrik	: 1300 VA / 2200 VA

ONE GATE SYSTEM
 MODERN MINIMALIS
 GREEN ENVIRONMENT



Greenland Sendang Residence
 Jl. Pangeran Cakrabuana,
 Sendang, Sumber, Cirebon,
 Jawa Barat 45611
 081822 6462

- ADELIA
- ALENA
- ALLURA
- AMARYLLIS
- AUSTIN
- BRITNEY
- CHESTER
- HELICONIA
- OLIVER
- ORCHID
- PLATO
- VALENCIA

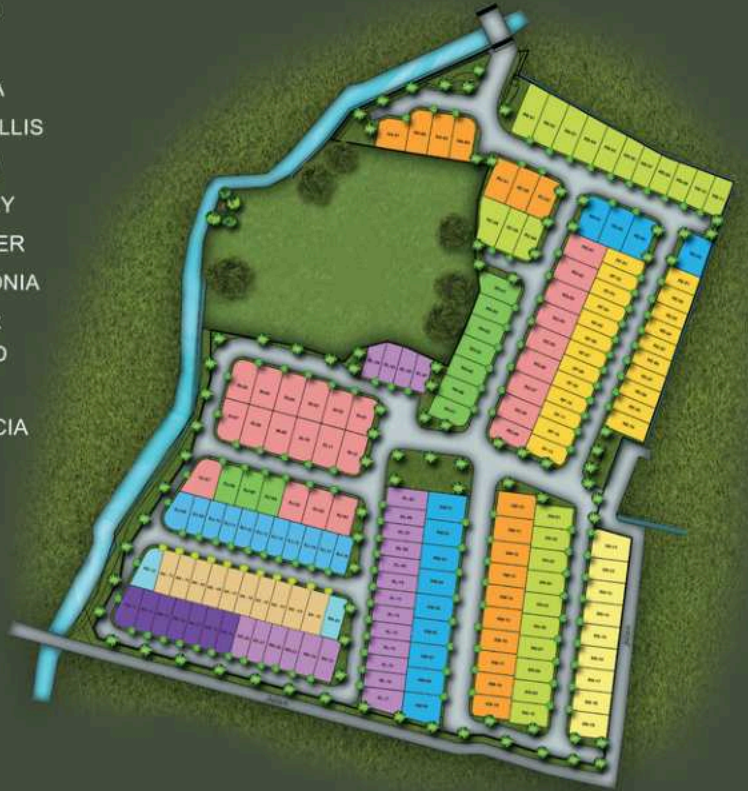

BRANCH OFFICE
 GREENLAND SENDANG RESIDENCE H 4
 TELP. 081 822 6462



Brosur atau bagian dari brosur ini merupakan alat bantu pemasaran dan penjualan, namun bukan merupakan bagian dari kontrak jual beli. Semua data dan gambar yang tercantum di brosur ini adalah benar berdasarkan situasi pada masa persiapan, perubahan yang terjadi sewaktu - waktu merupakan hak developer.

RIVIERA 1

HARGA PER 29 JUNI 2024

No	Blok Kav.	Muka		Nama	Luas		Harga	PEMBAYARAN LEWAT KREDIT					
					Type	Tanah		Sesudah PPN	Uang Muka	Pinjaman	5 Thn	10 Thn	15 Thn
1	RB09	2 lt	7	Plato	82	94	1,118,820,000	111,882,000	1,006,938,000	19,466,933	11,179,076	8,497,115	7,214,017
2	RB10	2 lt	7	Plato	82	96	1,130,480,000	113,048,000	1,017,432,000	19,669,811	11,295,581	8,585,669	7,289,199
3	RC03	2 lt	Ready Stock	Helliconia	91	127	SOLD						
4	RC05	2 lt	Ready Stock	Plato	85	112	SOLD						
5	RE06	1 lt	6	Britney	48	84	SOLD						
6	RE07	1 lt	6	Britney	48	86	SOLD						
7	RE08	1 lt	6	Britney	48	88	SOLD						

RIVIERA 2

HARGA PER 03 JANUARI 2025

No	Blok Kav.	Muka		Nama	Luas		Harga	PEMBAYARAN LEWAT KREDIT					
					Type	Tanah		Sesudah PPN	Uang Muka	Pinjaman	5 Thn	10 Thn	15 Thn
1	RI01	1 lt	Hook	Chester	65	121	SOLD						
2	RI02	1 lt	9	Chester	65	122	SOLD						
3	RI03	1 lt	9	Chester	65	135	1,124,430,000	56,221,500	1,068,208,500	20,651,463	11,859,304	9,014,150	7,652,977
4	RI04	1 lt	9	Chester	65	135	1,124,430,000	56,221,500	1,068,208,500	20,651,463	11,859,304	9,014,150	7,652,977
5	RI05	1 lt	9	Chester	65	135	SOLD						
6	RI06	1 lt	River V	Chester	65	132	SOLD						
7	RI07	1 lt	River V	Chester	65	132	SOLD						
8	RI08	1 lt	9	Chester	65	135	SOLD						
9	RI09	1 lt	9	Chester	65	135	1,124,430,000	56,221,500	1,068,208,500	20,651,463	11,859,304	9,014,150	7,652,977
10	RI10	1 lt	9	Chester	65	135	SOLD						
11	RI11	1 lt	9	Chester	65	135	1,124,430,000	56,221,500	1,068,208,500	20,651,463	11,859,304	9,014,150	7,652,977
12	RI12	1 lt	Hook	Chester	65	134	SOLD						
13	RJ01	1 lt	Hook	Chester	65	126	SOLD						
14	RJ02	1 lt	9	Chester	65	126	SOLD						
15	RJ03	1 lt	9	Chester	65	126	1,074,050,000	53,702,500	1,020,347,500	19,726,176	11,327,949	8,610,272	7,310,086
16	RJ04	1 lt	8	Allura	60	112	967,330,000	48,366,500	918,963,500	17,766,139	10,202,379	7,754,736	6,583,740
17	RJ05	1 lt	8	Allura	60	112	SOLD						
18	RJ06	1 lt	8	Allura	60	112	967,330,000	96,733,000	870,597,000	16,831,079	9,665,412	7,346,592	6,237,227
19	RJ07	1 lt	River V/Hook	Chester	65	141	SOLD						
20	RJ08	1 lt	River V/Hook	Adelia	48	105	SOLD						
21	RJ09	1 lt	6	Adelia	48	84	SOLD						
22	RJ10	1 lt	6	Adelia	48	84	742,520,000	37,126,000	705,394,000	13,637,242	7,831,320	5,952,515	5,053,662
23	RJ11	1 lt	6	Adelia	48	84	SOLD						
24	RJ12	1 lt	6	Adelia	48	84	SOLD						
25	RJ13	1 lt	6	Adelia	48	84	742,520,000	37,126,000	705,394,000	13,637,242	7,831,320	5,952,515	5,053,662
26	*RJ14	1 lt	6	Adelia	48	84	742,520,000	37,126,000	705,394,000	13,637,242	7,831,320	5,952,515	5,053,662
27	RJ15	1 lt	6	Adelia	48	84	SOLD						
28	RJ16	1 lt	6	Adelia	48	84	SOLD						
29	RJ17	1 lt	6	Adelia	48	84	SOLD						
30	RJ18	1 lt	Hook	Adelia	48	84	SOLD						
31	RK01	2 lt	7	Amaryllis	78	108	SOLD						
32	RK02	2 lt	7	Orchid	68	108	1,122,600,000	112,260,000	1,010,340,000	19,532,703	11,216,845	8,525,823	7,238,390
33	*RK03	2 lt	7	Orchid	68	108	1,122,600,000	112,260,000	1,010,340,000	19,532,703	11,216,845	8,525,823	7,238,390
34	RK04	2 lt	6	Orchid	68	93	1,034,560,000	103,456,000	931,104,000	18,000,849	10,337,163	7,857,185	6,670,718
35	RK05	2 lt	6	Orchid	68	93	1,034,560,000	103,456,000	931,104,000	18,000,849	10,337,163	7,857,185	6,670,718
36	RK06	2 lt	6	Orchid	68	93	1,034,560,000	103,456,000	931,104,000	18,000,849	10,337,163	7,857,185	6,670,718
37	RK07	2 lt	6	Orchid	68	93	1,034,560,000	103,456,000	931,104,000	18,000,849	10,337,163	7,857,185	6,670,718
38	RK08	2 lt	6	Orchid	68	93	1,034,560,000	103,456,000	931,104,000	18,000,849	10,337,163	7,857,185	6,670,718
39	RK09	2 lt	6	Orchid	68	93	1,034,560,000	103,456,000	931,104,000	18,000,849	10,337,163	7,857,185	6,670,718
40	RK10	2 lt	6	Orchid	68	93	1,034,560,000	103,456,000	931,104,000	18,000,849	10,337,163	7,857,185	6,670,718
41	RK11	2 lt	6	Orchid	68	93	1,034,560,000	103,456,000	931,104,000	18,000,849	10,337,163	7,857,185	6,670,718
42	RK12	2 lt	River V/Hook	Amaryllis	78	110	SOLD						
43	RK13	2 lt	River V/Hook	Alena	80	110	SOLD						
44	RK14	2 lt	6	Alena	80	93	SOLD						
45	RK15	2 lt	6	Alena	80	93	1,120,780,000	112,078,000	1,008,702,000	19,501,036	11,198,660	8,512,001	7,226,654
46	RK16	2 lt	6	Alena	80	93	1,120,780,000	112,078,000	1,008,702,000	19,501,036	11,198,660	8,512,001	7,226,654
47	RK17	2 lt	6	Alena	80	93	SOLD						
48	RK18	2 lt	6	Alena	80	93	SOLD						
49	RK19	2 lt	6	Alena	80	93	SOLD						
50	RK20	2 lt	6	Alena	80	93	SOLD						

51	RK21	2 It	6	Olliver	78	93							SOLD
52	RK22	2 It	6	Olliver	78	93							SOLD
53	RK23	2 It	6	Olliver	78	93							SOLD
54	RK24	2 It	7	Olliver	78	108							SOLD
55	RK25	2 It	7	Olliver	78	108							SOLD
56	RL01	2 It	6	Olliver	78	79	1,024,240,000	102,424,000	921,816,000	17,821,286	10,234,048	7,778,807	6,604,176
57	RL02	2 It	6	Olliver	78	85	1,059,460,000	105,946,000	953,514,000	18,434,097	10,585,960	8,046,293	6,831,270
58	RL03	2 It	6	Olliver	78	88	1,077,070,000	107,707,000	969,363,000	18,740,502	10,761,917	8,180,036	6,944,818
59	RL04	2 It	6	Olliver	78	78	1,018,360,000	101,836,000	916,524,000	17,718,977	10,175,295	7,734,150	6,566,263
60	RL05	2 It	6	Olliver	78	112	1,217,940,000	121,794,000	1,096,146,000	21,191,573	12,169,468	9,249,903	7,853,130
61	RL06	2 It	6	Olliver	78	96							SOLD
62	RL07	2 It	6	Olliver	78	96							SOLD
63	RL08	2 It	6	Olliver	78	96	1,124,020,000	112,402,000	1,011,618,000	19,557,410	11,231,034	8,536,608	7,247,546
64	RL09	2 It	6	Olliver	78	96	1,124,020,000	112,402,000	1,011,618,000	19,557,410	11,231,034	8,536,608	7,247,546
65	RL10	2 It	6	Olliver	78	96	1,124,020,000	112,402,000	1,011,618,000	19,557,410	11,231,034	8,536,608	7,247,546
66	RL11	2 It	6	Olliver	78	96	1,124,020,000	112,402,000	1,011,618,000	19,557,410	11,231,034	8,536,608	7,247,546
67	RL12	2 It	6	Olliver	78	96	1,124,020,000	112,402,000	1,011,618,000	19,557,410	11,231,034	8,536,608	7,247,546
68	RL13	2 It	6	Olliver	78	96	1,124,020,000	112,402,000	1,011,618,000	19,557,410	11,231,034	8,536,608	7,247,546
69	RL14	2 It	6	Olliver	78	96	1,124,020,000	112,402,000	1,011,618,000	19,557,410	11,231,034	8,536,608	7,247,546
70	RL15	2 It	6	Olliver	78	96	1,124,020,000	112,402,000	1,011,618,000	19,557,410	11,231,034	8,536,608	7,247,546
71	RL16	2 It	6	Olliver	78	96							SOLD
72	RL17	2 It	6	Olliver	78	130							SOLD
73	RM01	2 It	10	Austin	89	140							SOLD
74	RM02	2 It	9	Austin	89	126							SOLD
75	RM03	2 It	9	Austin	89	126							SOLD
76	RM04	2 It	9	Austin	89	126							SOLD
77	RM05	2 It	9	Austin	89	126							SOLD
78	RM06	2 It	9	Austin	89	126							SOLD
79	RM07	2 It	9	Austin	89	126							SOLD
80	RM08	2 It	9	Austin	89	126							SOLD
81	RM09	2 It	Hook	Austin	89	144							SOLD
82	RM10	2 It	9	Helliconia	89	126							SOLD
83	RM11	2 It	9	Helliconia	89	126							SOLD
84	RM12	2 It	8	Helliconia	89	112							SOLD
85	RM13	2 It	8	Helliconia	89	112							SOLD
86	RM14	2 It	8	Helliconia	89	112							SOLD
87	RM15	2 It	8	Helliconia	89	112							SOLD
88	RM16	2 It	8	Helliconia	89	112							SOLD
89	RM17	2 It	8	Helliconia	89	112							SOLD
90	RM18	2 It	8	Helliconia	89	112							SOLD
91	RM19	2 It	Hook	Helliconia	89	111							SOLD
92	RN01	2 It	8	Plato	82	112							SOLD
93	RN02	2 It	8	Plato	82	112							SOLD
94	RN03	2 It	8	Plato	82	112							SOLD
95	RN04	2 It	8	Plato	82	112							SOLD
96	RN05	2 It	8	Plato	82	112							SOLD
97	RN06	2 It	8	Plato	82	112	1,291,870,000	129,187,000	1,162,683,000	22,477,920	12,908,165	9,811,380	8,329,822
98	RN07	2 It	8	Plato	82	112	1,291,870,000	129,187,000	1,162,683,000	22,477,920	12,908,165	9,811,380	8,329,822
99	RN08	2 It	8	Plato	82	112	1,291,870,000	129,187,000	1,162,683,000	22,477,920	12,908,165	9,811,380	8,329,822
100	RN09	2 It	8	Plato	82	112							SOLD
101	RN10	2 It	Hook	Plato	82	112							SOLD
102	RN11	2 It	10	Vallencia	82	136							SOLD
103	RN12	2 It	8	Vallencia	82	112							SOLD
104	RN13	2 It	8	Vallencia	82	112							SOLD
105	RN14	2 It	8	Vallencia	82	112							SOLD
106	RN15	2 It	8	Vallencia	82	112							SOLD
107	RN16	2 It	8	Vallencia	82	112	1,291,870,000	129,187,000	1,162,683,000	22,477,920	12,908,165	9,811,380	8,329,822
108	RN17	2 It	8	Vallencia	82	112							SOLD
109	RN18	2 It	8	Vallencia	82	112							SOLD
110	RN19	2 It	Hook	Vallencia	82	126							SOLD

Keterangan

- Harga sudah termasuk penambahan luas tanah
- Tanda Pesan NUP & Booking fee sebagai bukti pesan kavling tidak mengikat harga
- Booking fee 1 lantai Rp.4.000.000 - 2 lantai Rp 5.000.000
- Booking Fee /DP/Pembayaran dilakukan secara transfer ke Rek PT Bangun Cipta Prima
- Apabila terjadi pembatalan, maka booking fee tidak dapat dikembalikan atau HANGUS
- Uang Muka / DP dibayarkan 2 minggu setelah Booking fee
- Cara Pembayaran
 - Cash bertahap dari Harga jual dapat diangsur 18X tanpa bunga
 - Tunai Cash dalam 1 bulan
- Harga Belum termasuk Biaya AJB ,BBN sertipikat dan pajak / biaya lain yang timbul
- Pembayaran tidak sesuai waktu dianggap mengundurkan diri
- Harga belum termasuk Biaya Notaris ,Biaya Pajak , .Balik Nama ,Biaya KPR & Biaya Lain yang timbul oleh peraturan Pemerintah
- Harga Dapat berubah ubah sewaktu waktu
- Sebagai bukti pembayaran resmi , Harus ada Kuitansi Print out dan pemberitahuan melalui sms/email yang dikeluarkan oleh PT Bangun Cipta Prima
- Kelengkapan berkas KPR maximum 2 minggu setelah Booking fee

Persyaratan KPR

A.Pengusaha

- Fc KTP Suami Istri -KK- Pas Photo 3x4
- Fc Akta Nikah/ Cerai/ Pisah
- Fc WNI dan Ganti Nama
- NPWP suami /istri
- SIUP/ NIB/ TDP/SKU
- Fc Akta Pendirian & Perubahan terakhir CV/PT
- Fc Rekening koran /tabungan 3 bulan terakhir
- Fc Laporan Keuangan
- Fc Surat Ijin Praktek & SK Pengangkatan (untuk Profesional dokter & Notaris)
- Fc BPJS

B.Karyawan / Pegawai

- Fc KTP Suami Istri -KK- Pas Photo 3x4
- Fc Akta Nikah/ Cerai/ Pisah
- Fc WNI dan Ganti Nama
- NPWP suami /istri
- Fc tabungan 3 bulan terakhir
- Pas Photo 3x4 (suami Istri) masing masing 1
- Asli Surat Keterangan dari Perusahaan & Slip Gaji
- Fc BPJS

FREE/ BEBASBIAYA BPHTB
FREE/ SUBSIDI BIAYA BBN ,KPR & ASURANSI

KANTOR : PERUMAHAN
GREENLAND SENDANG,
JL. PANGERAN
CAKRABUANA, SUMBER